

# PTO Switch 4mm Series

P2 = Blocked or Connected to Double Acting P.T.O. Cylinder

P1 = To P.T.O. Cylinder

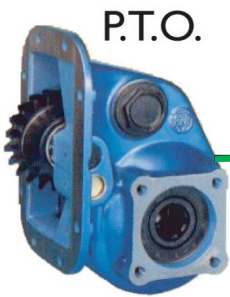

P.T.O.

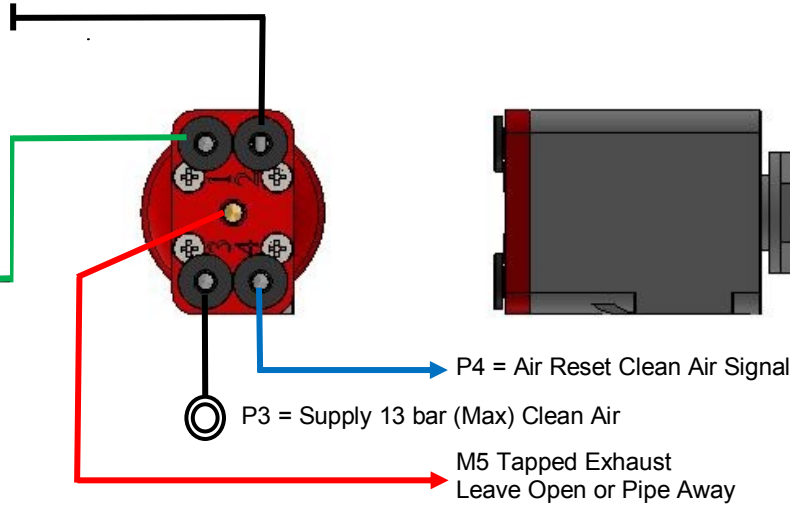

## Air Pilot Reset

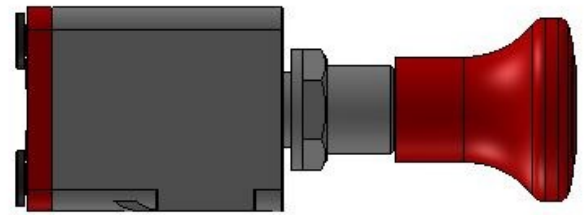

**Type Code**  
**ACV-R4M-AR**

P2 = Blocked or Connected to Double Acting P.T.O. Cylinder

P1 = To P.T.O. Cylinder



P3 = Supply 13 bar (Max) Clean Air

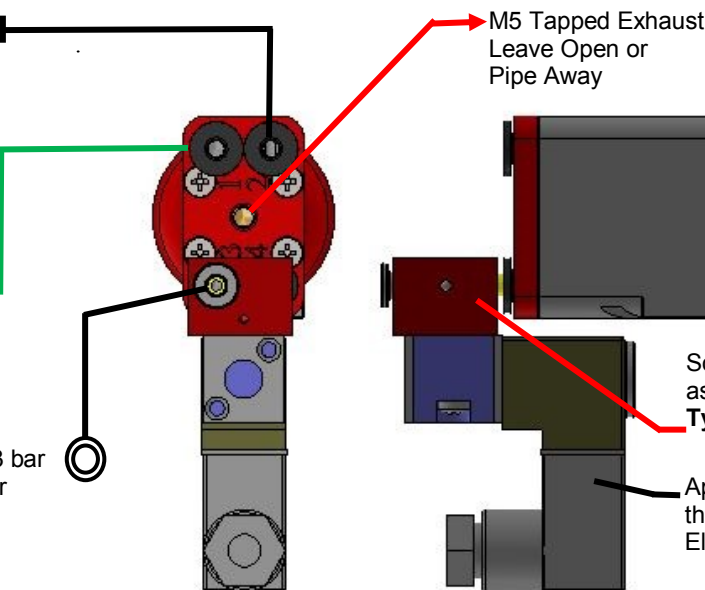

## Solenoid Pilot Reset

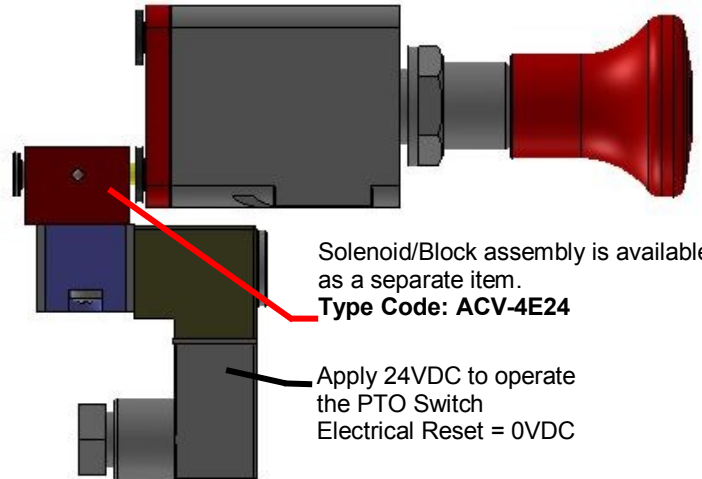

Solenoid/Block assembly is available as a separate item.  
**Type Code: ACV-4E24**

Apply 24VDC to operate the PTO Switch  
Electrical Reset = 0VDC

**Type Code**  
**ACV-R4M-AR-B**

P2 = Blocked or Connected to Double Acting P.T.O. Cylinder

P1 = To P.T.O. Cylinder



P3 = Supply 13 bar (Max) Clean Air

P4 = Permanently Blocked

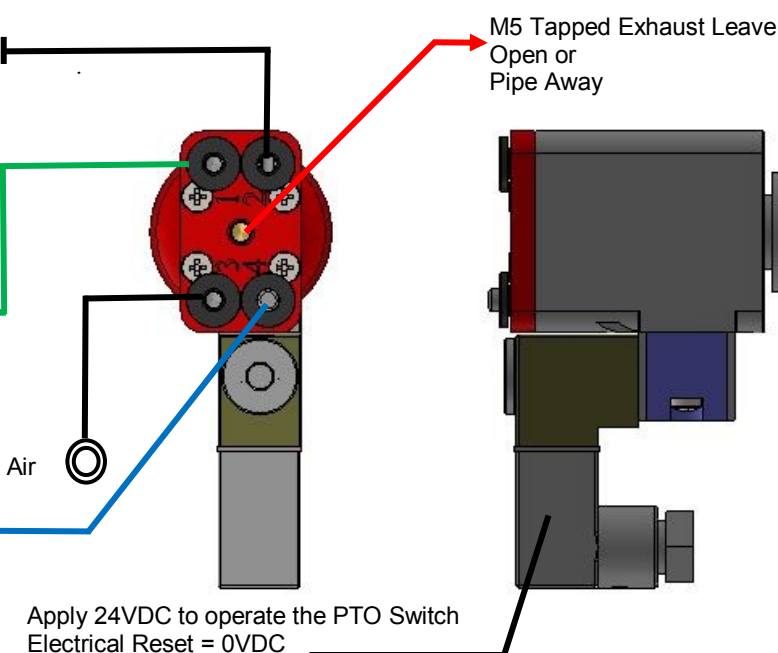

## Integral Solenoid Pilot Reset

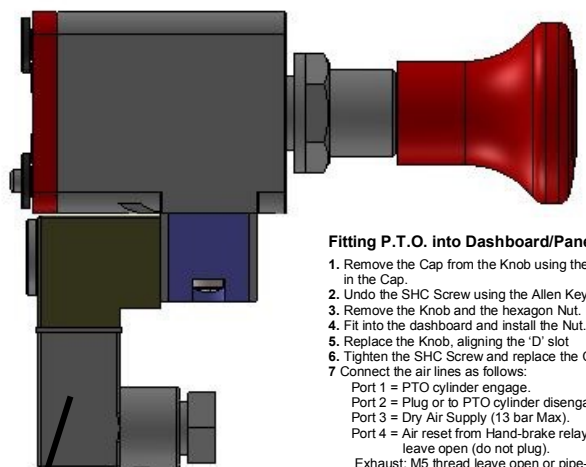

### Fitting P.T.O. into Dashboard/Panel

1. Remove the Cap from the Knob using the edge slot in the Cap.
2. Undo the SHC Screw using the Allen Key.
3. Remove the Knob and the hexagon Nut.
4. Fit into the dashboard and install the Nut.
5. Replace the Knob, aligning the 'D' slot
6. Tighten the SHC Screw and replace the Cap.
7. Connect the air lines as follows:  
Port 1 = PTO cylinder engage.  
Port 2 = Plug or to PTO cylinder disengage.  
Port 3 = Dry Air Supply (13 bar Max).  
Port 4 = Air reset from Hand-brake relay or leave open (do not plug).  
Exhaust: M5 thread leave open or pipe-away.
8. Port 4 is not used in the electrical reset version ACV-4M-AR-B
9. For ACV-4M-AR-B and SP-B versions connect the electrical connector pins 1 & 2 to a 24VDC signal to operate the PTO (not polarity sensitive)

Apply 24VDC to operate the PTO Switch  
Electrical Reset = 0VDC

**Type Code**  
**ACV-R4M-SP-B**

